

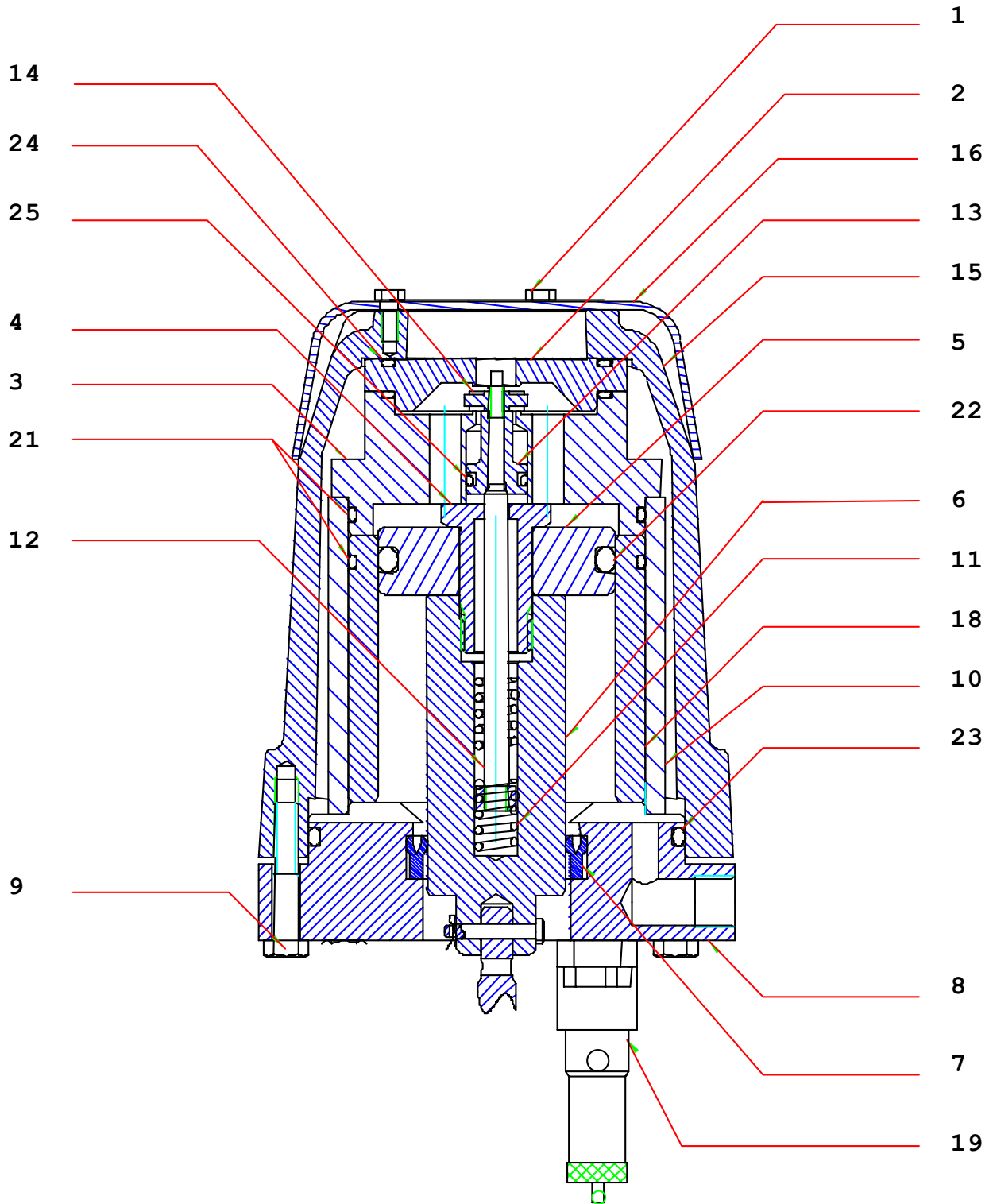

MOTEUR A AIR / AIR MOTOR - Mod. 170/2

144.942.100



Moteur à air / Air motor # 144.942.100

Ind	#	Désignation	Description	Qté
1	933.011.141	Vis HM 4 x 10	Screw, HM 4 x 10	3
2	044.942.104	Couvercle	Cover	1
3	044.850.107	Corps inverseur	Body, reversing block	1
4	044.550.006	Vis piston air	Screw, air piston	1
5	044.942.102	Piston air supérieur	Air piston, upper	1
6	044.850.102	Piston air inférieur	Air piston, lower	1
7	109.210.401	Joint U (pochette de 10)	Seal, "U" (pack of 10)	1
8	044.850.101	Corps fond de cylindre	Lower support	1
9	933.011.443	Vis HM 6 x 35	Screw, HM 6 x 35	3
10	044.850.106	Cylindre air	Air cylinder	1
11	050.313.207	Ressort	Spring	2
12	044.850.103	Tige de commande assemblée	Control rod assembly	1
13	044.940.051	Porte-joint	Seal-holder	1
14	044.550.013	Clapet	Valve	1
15	044.850.109	Cloche	Cover	1
16	044.850.110	Silencieux	Silencer	1
18	044.942.101	Chemise cylindre	Sleeve, cylinder	1
19	903.080.401	Soupape de décharge 6,5 bar	Discharge valve, 6.5 bar / 94 psi	1
21	909.420.259	Joint O Ring	O-Ring	2
22	909.130.334	Bague R32	Ring, R32	1
23	909.420.108	Joint O Ring	O-Ring	1
24	909.420.220	Joint O Ring	O-Ring	2
25	109.130.311	Bague R9 (par 10)	Ring, R9 (pack of 10)	1
	144.942.099	Pochette de joints / Package of seals (ind. 7, 11, 14, 21, 22, 23, 24, 25)		1